

DRAWING NUMBER
51/30

DRAWING NUMBER

DRAWING NUMBER

DRAWING NUMBER

P.U.D. DENSITY TABULATION

PLAT	AREA ACRES	NO. OF UNITS	PLAT DENSITY D.U./ACRE	AGGREGATE		TOTALS
				AGGR. ACRES	NO. OF UNITS	OVERALL DENSITY D.U./ACRE
PLAT NO. 1	33.89	106	3.12	33.89	106	3.12
PLAT NO. 2	31.37	160	5.10	65.26	266	4.07
PLAT NO. 3	5.13	0	0.00	70.39	266	3.77
PLAT NO. 4-A	20.81	0	0.00	91.20	266	2.92
PLAT NO. 4-B	30.04	300	9.88	121.24	566	4.67
PLAT NO. 5	9.40	80	8.51	130.64	646	4.94

A PORTION OF A P.U.D.
LAKESIDE GREEN-PLAT NO. 5
 SECTION 12, TOWNSHIP 43 SOUTH, RANGE 42 EAST
 PALM BEACH COUNTY, FLORIDA
 IN 2 SHEETS SHEET NO. 1
 FEBRUARY, 1985

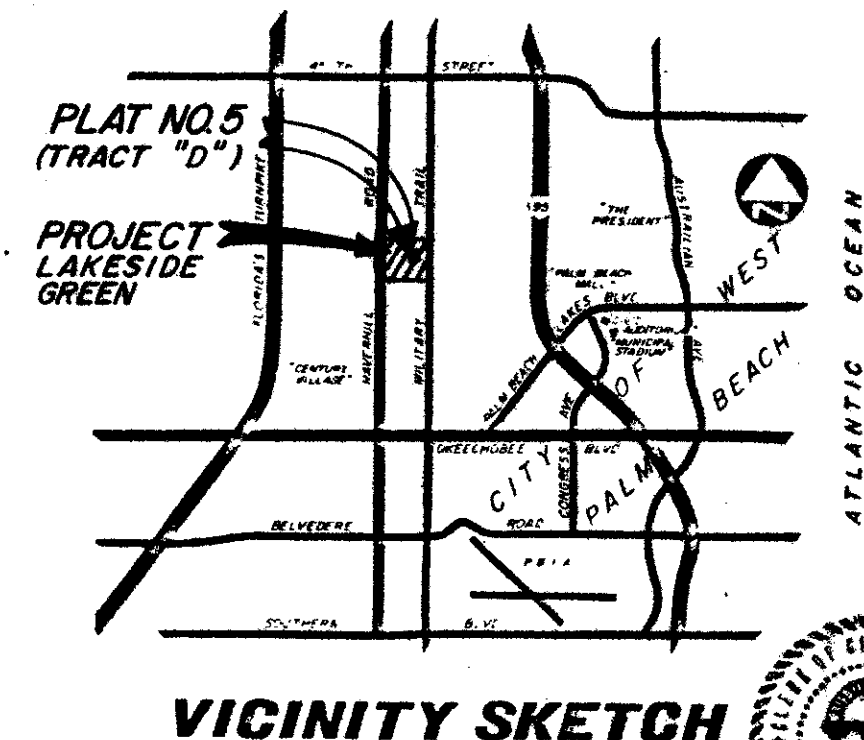

STATE OF FLORIDA
 COUNTY OF PALM BEACH
 This Plat was filed for record on 11/11/84
 this 9th day of May
 1985, and duly recorded in Plat Book No.
51 on pages 307-31
 JOHN B. DUNKLE, Clerk, Circuit Court
 By Jacobus J. Pallas, D.C.

DEDICATION AND RESERVATION

STATE OF FLORIDA SS
COUNTY OF PALM BEACH

KNOW ALL MEN BY THESE PRESENTS THAT THE ENGLE GROUP, INC., A FLORIDA CORPORATION, OWNER OF THE LAND SHOWN HEREON, BEING IN SECTION 12, TOWNSHIP 43 SOUTH, RANGE 42 EAST, PALM BEACH COUNTY, FLORIDA, SHOWN HEREON AS LAKESIDE GREEN - PLAT NO. 5, BEING MORE PARTICULARLY DESCRIBED AS FOLLOWS:

A PARCEL OF LAND LYING IN THE SOUTHWEST QUARTER OF SECTION 12, TOWNSHIP 43 SOUTH, RANGE 42 EAST, PALM BEACH COUNTY, FLORIDA, SAID PARCEL OF LAND BEING MORE PARTICULARLY DESCRIBED AS FOLLOWS:

COMMENCING AT THE NORTHEAST CORNER OF THE PLAT LAKESIDE GREEN PLAT NO. 2, AS RECORDED IN PLAT BOOK 48, PAGE 136-137 OF THE PUBLIC RECORDS OF PALM BEACH COUNTY, FLORIDA; THENCE WITH A BEARING OF NORTH 89° 51' 00" WEST, ALONG THE NORTH LINE OF PLAT NO. 2, LAKESIDE GREEN, A DISTANCE OF 615.00 FEET TO THE POINT OF BEGINNING; THENCE CONTINUE ALONG THE NORTH LINE OF LAKESIDE GREEN PLAT NO. 2, WITH A BEARING OF NORTH 89° 51' 00" WEST, A DISTANCE OF 435.00 FEET TO A POINT; THENCE WITH A BEARING OF NORTH 28° 51' 08" WEST, A DISTANCE OF 255.34 FEET TO A POINT; THENCE NORTH 76° 30' 00" EAST, A DISTANCE OF 38.22 FEET; THENCE NORTH 12° 30' 00" EAST, A DISTANCE OF 63.12 FEET; THENCE NORTH 0° 09' 00" EAST, A DISTANCE OF 195.00 FEET; THENCE NORTH 5° 00' 00" WEST, A DISTANCE OF 135.00 FEET; THENCE NORTH 6° 30' 00" EAST, A DISTANCE OF 105.00 FEET; THENCE NORTH 0° 09' 00" EAST, A DISTANCE OF 105.00 FEET; THENCE SOUTH 88° 13' 45" EAST, A DISTANCE OF 295.00 FEET TO A POINT; THENCE WITH A CURVE TO THE RIGHT HAVING A RADIUS OF 220.00 FEET, A CENTRAL ANGLE OF 88° 22' 45", AND AN ARC LENGTH OF 339.35 FEET TO A POINT; THENCE WITH A BEARING OF SOUTH 0° 09' 00" WEST, A DISTANCE OF 604.56 FEET MORE OR LESS TO THE POINT OF BEGINNING.

CONTAINING 9.402 ACRES, MORE OR LESS.

STATE OF FLORIDA SS
COUNTY OF PALM BEACH

THE NORTHERN PALM BEACH COUNTY WATER CONTROL DISTRICT HAS REVIEWED THIS PLAT AND ACKNOWLEDGES THERE ARE NO DEDICATIONS TO THE NORTHERN PALM BEACH COUNTY WATER CONTROL DISTRICT AND THAT SAID DISTRICT HAS NO MAINTENANCE RESPONSIBILITIES WITHIN THIS PLAT.

DATE March 29, 1985 NORTHERN PALM BEACH COUNTY WATER CONTROL DISTRICT

ATTEST: Donald C. Walker
DONALD C. WALKER, PRESIDENT
BOARD OF SUPERVISORS

HAS CAUSED THE SAME TO BE SURVEYED AND PLATTED AS SHOWN HEREON AND DOES HEREBY DEDICATE AS FOLLOWS:

- TRACTS "A", "B" AND "C" AS SHOWN HEREON ARE HEREBY RESERVED UNTO THE ENGLE GROUP, INC., ITS SUCCESSORS OR ASSIGNS AS COMMON AREAS FOR PARKING, ACCESS, LANDSCAPING, BUFFER AND RECREATIONAL PURPOSES WITHOUT RECOURSE TO PALM BEACH COUNTY.
- EASEMENTS:
 - UTILITY AND DRAINAGE EASEMENTS - THE UTILITY EASEMENTS AND DRAINAGE EASEMENTS AS SHOWN ARE HEREBY DEDICATED IN PERPETUITY FOR THE CONSTRUCTION AND MAINTENANCE OF UTILITIES AND DRAINAGE, WITHOUT RECOURSE TO THE NORTHERN PALM BEACH COUNTY WATER CONTROL DISTRICT.
 - LIMITED ACCESS EASEMENTS - THE LIMITED ACCESS EASEMENTS AS SHOWN ARE DEDICATED TO THE BOARD OF COUNTY COMMISSIONERS OF PALM BEACH COUNTY, FLORIDA, FOR THE PURPOSES OF CONTROL AND JURISDICTION OVER ACCESS RIGHTS.
- THE 20' ACCESS TRACTS AS SHOWN HEREON ARE HEREBY DEDICATED TO THE ENGLE GROUP, INC., ITS SUCCESSORS OR ASSIGNS, FOR INGRESS, EGRESS, DRAINAGE AND UTILITY EASEMENT PURPOSES AND ARE THE PERPETUAL MAINTENANCE OBLIGATION OF SAID CORPORATION, ITS SUCCESSORS OR ASSIGNS, WITHOUT RECOURSE TO PALM BEACH COUNTY AND WITHOUT RECOURSE TO THE NORTHERN PALM BEACH COUNTY WATER CONTROL DISTRICT.

IN WITNESS WHEREOF, THE ENGLE GROUP, INC. HAS CAUSED THESE PRESENTS TO BE SIGNED BY ITS PRESIDENT AND ATTESTED BY ITS VICE-PRESIDENT AND ITS CORPORATE SEAL TO BE AFFIXED HERETO BY AND WITH THE AUTHORITY OF ITS BOARD OF DIRECTORS THIS 26th DAY OF MARCH A.D., 1985

ATTEST:
Harry Englestein
Vice-President

ACKNOWLEDGEMENT

STATE OF FLORIDA SS
COUNTY OF PALM BEACH

BEFORE ME PERSONALLY APPEARED ALEC ENGLESTEIN AND HARRY ENGLESTEIN, TO BE WELL KNOWN, AND KNOWN TO ME TO BE THE INDIVIDUALS DESCRIBED IN AND WHO EXECUTED THE FOREGOING INSTRUMENT AS PRESIDENT AND VICE PRESIDENT OF THE ENGLE GROUP, INC., A FLORIDA CORPORATION, AND SEVERALLY ACKNOWLEDGED TO AND BEFORE ME THAT THEY EXECUTED SUCH INSTRUMENT AS SUCH OFFICERS OF SAID CORPORATION, AND THAT THE SEAL AFFIXED TO THE FOREGOING INSTRUMENT IS THE CORPORATE SEAL OF SAID CORPORATION AND THAT IT WAS AFFIXED TO SAID INSTRUMENT BY DUE AND REGULAR CORPORATE AUTHORITY, AND THAT SAID INSTRUMENT IS THE FREE ACT AND DEED OF SAID CORPORATION.

WITNESS MY HAND AND OFFICIAL SEAL THIS 26th DAY OF March 1985

NOTARY PUBLIC
Patricia Jones

MY COMMISSION EXPIRES March 4, 1986

MORTGAGEE'S CONSENT

STATE OF FLORIDA SS
COUNTY OF PALM BEACH

THE UNDERSIGNED HEREBY CERTIFIES THAT IT IS THE HOLDER OF A MORTGAGE UPON THE PROPERTY DESCRIBED HEREON AND DOES HEREBY JOIN IN AND CONSENT TO THE DEDICATION OF THE LAND DESCRIBED IN SAID DEDICATION BY THE OWNER THERE-OF AND AGREES THAT ITS MORTGAGE WHICH IS RECORDED IN OFFICIAL RECORD BOOK 496 AT PAGE 370 OF THE PUBLIC RECORDS OF PALM BEACH COUNTY, FLORIDA SHALL BE SUBORDINATED TO THE DEDICATION SHOWN HEREON.

IN WITNESS WHEREOF, THE SAID CORPORATION HAS CAUSED THESE PRESENTS TO BE SIGNED BY ITS Vice President AND ATTESTED TO BY ITS Vice President AND ITS CORPORATE SEAL TO BE AFFIXED HERETO BY AND WITH THE AUTHORITY OF ITS BOARD OF DIRECTORS THIS 26th DAY OF April A.D. 1985

ATTEST: E. Betty McGhee
FIRST AMERICAN BANK AND TRUST
BY: Barbara H. Vincent
V.P.

ACKNOWLEDGEMENT

STATE OF FLORIDA SS
COUNTY OF PALM BEACH

BEFORE ME PERSONALLY APPEARED Barbara H. Vincent AND E. Betty McGhee TO BE WELL KNOWN, AND KNOWN TO ME TO BE THE INDIVIDUALS DESCRIBED IN AND WHO EXECUTED THE FOREGOING INSTRUMENT AS Vice President AND Vice President OF THE ABOVE NAMED First American Bank and Trust, AND SEVERALLY ACKNOWLEDGED TO AND BEFORE ME THAT THEY EXECUTED SUCH INSTRUMENT AS Vice President AND Vice President RESPECTIVELY, OF SAID CORPORATION, AND THAT THE SEAL AFFIXED TO THE FOREGOING INSTRUMENT IS THE CORPORATE SEAL OF THE SAID CORPORATION AND THAT IT WAS AFFIXED TO SAID INSTRUMENT BY DUE AND REGULAR CORPORATE AUTHORITY AND THAT SAID INSTRUMENT IS THE FREE ACT AND DEED OF SAID CORPORATION.

WITNESS MY HAND AND OFFICIAL SEAL THIS 2nd DAY OF April A.D. 1985

WITNESS MY HAND AND OFFICIAL SEAL THIS 2nd DAY OF April A.D. 1985.

MY COMMISSION EXPIRES: 6/9/86 Richard J. Rain
NOTARY PUBLIC

TITLE CERTIFICATION

STATE OF FLORIDA
COUNTY OF PALM BEACH

I, JOEL P. KOBPEL, A DULY LICENSED ATTORNEY IN THE STATE OF FLORIDA, DO HEREBY CERTIFY THAT I HAVE EXAMINED THE TITLE TO THE HEREON DESCRIBED PROPERTY, THAT I FIND THE TITLE TO THE PROPERTY IS VESTED TO THE ENGLE GROUP, INC.; THAT THE CURRENT TAXES HAVE BEEN PAID; AND THAT THE PROPERTY IS ENCUMBERED BY THE MORTGAGES SHOWN HEREON; AND THAT I FIND THAT ALL MORTGAGES ARE SHOWN AND ARE TRUE AND CORRECT.

MARCH 26, 1985
Joel P. Koppel
ATTORNEY AT LAW, LICENSED IN FLORIDA

COUNTY APPROVALS

BOARD OF COUNTY COMMISSIONERS OF PALM BEACH COUNTY, FLORIDA:

THIS PLAT IS HEREBY APPROVED FOR RECORD THIS 7 DAY OF May A.D., 1985

BY: Kenneth M. Adams
KENNETH M. ADAMS, CHAIRMAN

ATTEST:

JOHN B. DUNKLE, CLERK
BY: Elizabeth P. ...
DEPUTY CLERK

COUNTY ENGINEER

THIS PLAT IS HERBY APPROVED FOR RECORD THIS 7 DAY OF May A.D., 1985

BY: H.F. Kahler
H.F. KAHLERT, COUNTY ENGINEER

NOTES:

- PERMANENT REFERENCE MONUMENTS ARE DESIGNATED THUSLY:
- PERMANENT CONTROL POINTS ARE DESIGNATED THUSLY:
- BUILDING SETBACK LINES SHALL BE AS REQUIRED BY ORDINANCES OF PALM BEACH COUNTY, FLORIDA.
- A. NO BUILDINGS OR ANY KIND OF CONSTRUCTION SHALL BE PLACED ON UTILITY OR DRAINAGE EASEMENTS.
B. NO STRUCTURES, TREES OR SHRUBS SHALL BE PLACED ON DRAINAGE EASEMENTS.
C. APPROVAL OF LANDSCAPING ON UTILITY EASEMENT SHALL BE ONLY WITH THE APPROVAL OF ALL UTILITIES OCCUPYING SAME.
- IN INSTANCES WHERE DRAINAGE AND UTILITY EASEMENTS INTERSECT, THE AREAS OF INTERSECTION ARE DRAINAGE AND UTILITY EASEMENTS. CONSTRUCTION, OPERATION AND MAINTENANCE OF UTILITIES IN THESE AREAS OF INTERSECTION SHALL NOT INTERFERE WITH THE CONSTRUCTION, OPERATION AND MAINTENANCE OF DRAINAGE FACILITIES LOCATED THEREIN.
- BEARINGS CITED HEREIN ARE IN THE MERIDIAN OF THE FLORIDA STATE PLANE COORDINATE SYSTEM.

SURVEYOR'S CERTIFICATION

STATE OF FLORIDA SS
COUNTY OF PALM BEACH

I HEREBY CERTIFY THAT THE PLAT SHOWN HEREON IS A TRUE AND CORRECT REPRESENTATION OF A SURVEY, MADE UNDER MY RESPONSIBLE DIRECTION AND SUPERVISION, AND THAT SAID SURVEY IS ACCURATE TO THE BEST OF MY KNOWLEDGE AND BELIEF AND THAT (P.R.M.'S) PERMANENT REFERENCE MONUMENTS HAVE BEEN SET AND THAT (P.C.P.'S) PERMANENT CONTROL POINTS WILL BE SET UNDER THE GUARANTEES POSTED WITH PALM BEACH COUNTY FOR THE REQUIRED IMPROVEMENTS; AND FURTHER THAT THE SURVEY DATA COMPLIES WITH ALL THE REQUIREMENTS OF CHAPTER 177, FLORIDA STATUTES, AS AMENDED, AND ORDINANCES OF PALM BEACH COUNTY, FLORIDA.

DATE: April 3rd 1985
Joseph M. Tucker
JOSEPH M. TUCKER
FLORIDA CERTIFICATE NO. 3285

THIS INSTRUMENT WAS PREPARED BY JOSEPH M. TUCKER IN THE OFFICES OF ROSSI AND MALAVASI ENGINEERS, INC., 1500 PALM BEACH LAKES BLVD. WEST PALM BEACH, FLORIDA 33401 PHONE: 737-6546

ROSSI AND MALAVASI ENGINEERS, INC. WEST PALM BEACH, FLORIDA

A PORTION OF A P.U.D. LAKESIDE GREEN-PLAT NO. 5 IN 2 SHEETS SHEET NO. 1

Date	FEBRUARY, 1985	Designed	R. ANDERSON
Drawn	D. FREDERICK	Checked	

